

Dual Control Lever
ST-2200 For Double Gear
ST-2203 For Triple Gear

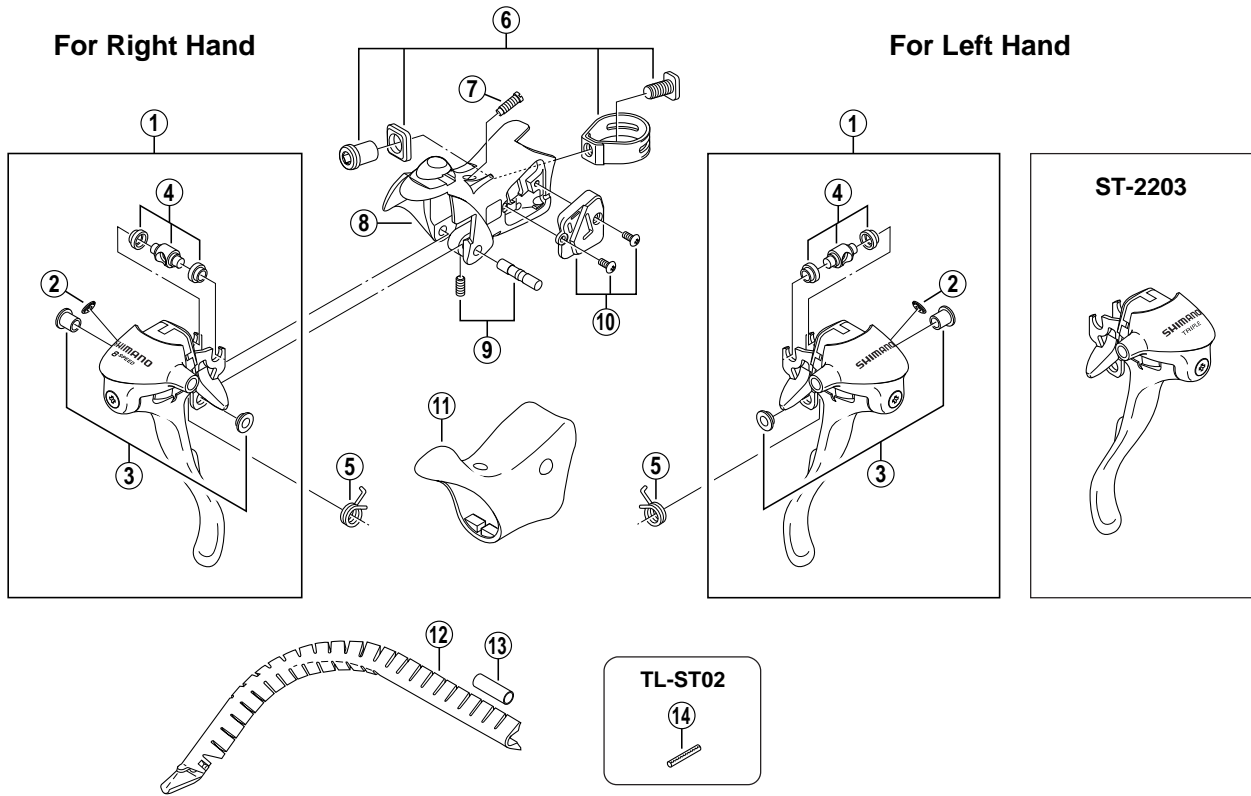

ITEM NO.	SHIMANO CODE NO.	DESCRIPTION	INTERCHANGEABILITY
1	Y-6LX 98010	R.H. Main Lever Assembly	
	Y-6LX 98020	L.H. Main Lever Assembly for ST-2200	
	Y-6LZ 98010	L.H. Main Lever Assembly for ST-2203	
2	Y-6CU39000	Cap	A
3	Y-85Z 98010	Lever Axle Bush Unit	A
4	Y-6CU98050	Cable Hook Unit	A
5	Y-6BD75000	R.H. Return Spring	A
	Y-6BD74000	L.H. Return Spring	A
6	Y-6BD98120	Clamp Band Unit (φ 23.8 mm – φ 24.2 mm)	A
7	Y-6CU87000	Grip Adjusting Screw (M4 x 11.6)	A
8	Y-6CU89100	R.H. Bracket	B
	Y-6CU89110	L.H. Bracket for ST-2200	B
	Y-6CU89210	L.H. Bracket for ST-2203	B
9	Y-6CU98080	Lever Axle & Fixing Screw	A
10	Y-6LX 98030	R.H. Water-Proof Cap & Fixing Screws (M3 x 6.5)	A
	Y-6LX 98040	L.H. Water-Proof Cap & Fixing Screws (M3 x 6.5)	A
11	Y-6CU98040	Bracket Covers (Pair)	A
12	Y-86B 90010	Outer Cable Guide	A
13	Y-877 11000	Outer Cable Joint	A
14	Y-130 03100	Return Spring Installation Tool (TL-ST02)	A

A: Same parts.

B: Parts are usable, but differ in materials, appearance, finish, size, etc.

Absence of mark indicates non-interchangeability.

ST-3300

0605-2558

Specifications are subject to change without notice.

SHIMANO