

# DISC ROTOR

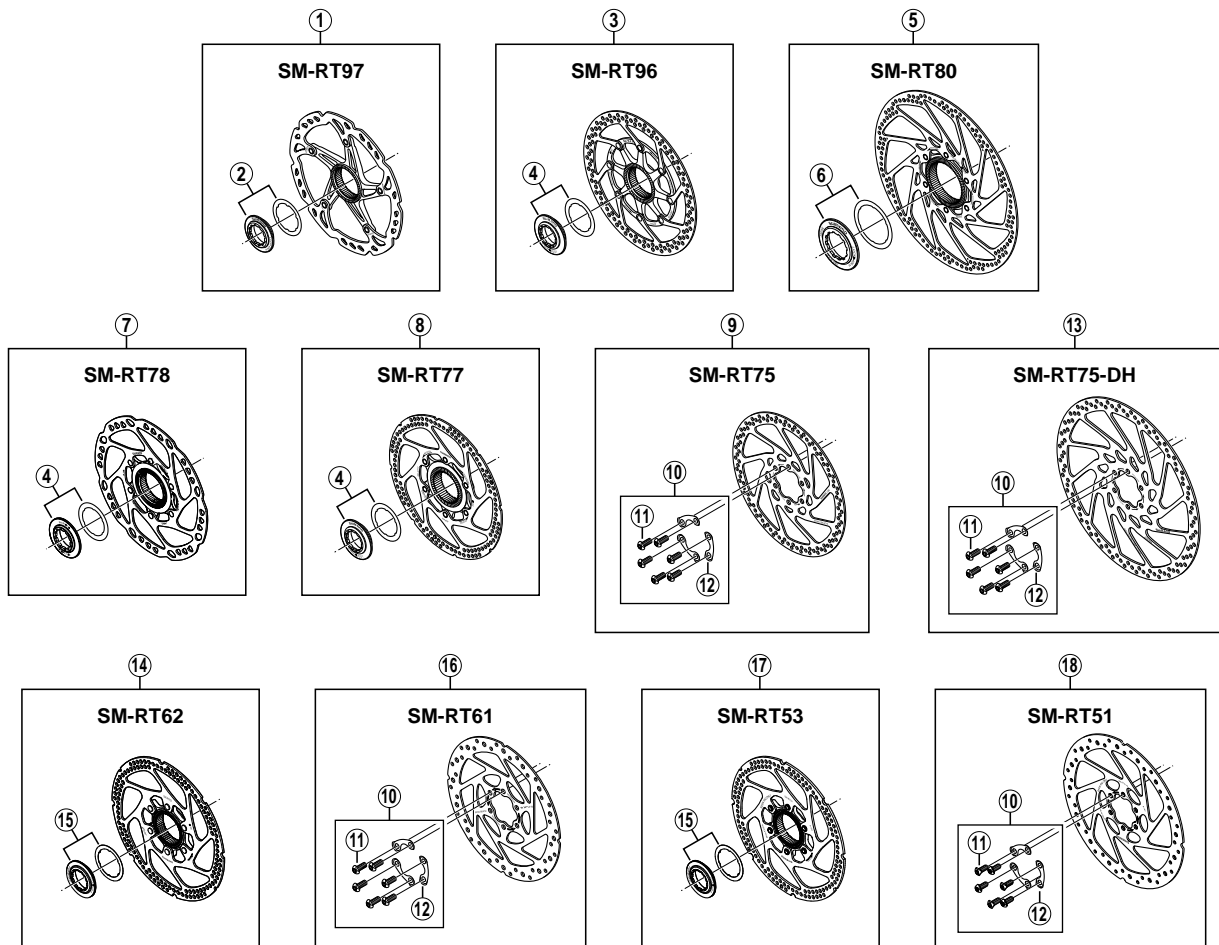

ITEM NO.	SHIMANO CODE NO.	DESCRIPTION
1	Y-8HN98040	SM-RT97SS Disc Rotor Unit ( $\phi$ 140 mm)
	Y-8HN98010	SM-RT97 Disc Rotor Unit ( $\phi$ 160 mm)
	Y-8HN98020	SM-RT97M Disc Rotor Unit ( $\phi$ 180 mm)
	Y-8HN98030	SM-RT97L Disc Rotor Unit ( $\phi$ 203 mm)
2	Y-8HN98050	Lock Ring & Washer for SM-RT97
3	Y-8CL98080	SM-RT96 Disc Rotor Unit ( $\phi$ 160 mm)
4	Y-8CL98090	Lock Ring & Washer for SM-RT96/RT78/RT77
5	Y-8HU98010	SM-RT80 Disc Rotor Unit ( $\phi$ 203 mm) / Oversized Center Lock
	Y-8HU98020	SM-RT80S Disc Rotor Unit ( $\phi$ 160 mm) / Oversized Center Lock
6	Y-8HU98030	Lock Ring & Washer for SM-RT80 / Oversized Center Lock
* 7	Y-8HJ98010	SM-RT78 Disc Rotor Unit ( $\phi$ 160 mm)
* 7	Y-8HJ98020	SM-RT78M Disc Rotor Unit ( $\phi$ 180 mm)
* 7	Y-8HJ98030	SM-RT78L Disc Rotor Unit ( $\phi$ 203 mm)
8	Y-8HV98010	SM-RT77 Disc Rotor Unit ( $\phi$ 160 mm)
	Y-8HV98020	SM-RT77L Disc Rotor Unit ( $\phi$ 203 mm)
9	Y-81898010	SM-RT75 Disc Rotor Unit ( $\phi$ 160 mm)
	Y-81898020	SM-RT75M Disc Rotor Unit ( $\phi$ 170 mm) for Post Type Mount
	Y-81898080	SM-RT75MA Disc Rotor Unit ( $\phi$ 180 mm)
10	Y-81898030	Disc Rotor Fixing Bolt & Plate for SM-RT75/RT75-DH/RT61/RT51
11	Y-81802001	Disc Rotor Fixing Bolt for SM-RT75/RT75-DH/RT61/RT51
12	Y-81803000	Disc Rotor Fixing Plate for SM-RT75/RT75-DH/RT61/RT51
13	Y-81898060	SM-RT75-DH Disc Rotor Unit ( $\phi$ 203 mm)
14	Y-8HS98010	SM-RT62 Disc Rotor Unit ( $\phi$ 160 mm)
	Y-8HS98060	SM-RT62M Disc Rotor Unit ( $\phi$ 180 mm)
	Y-8HS98020	SM-RT62L Disc Rotor Unit ( $\phi$ 203 mm)
15	Y-8HS98030	Lock Ring & Washer for SM-RT62/RT53
16	Y-8HY98010	SM-RT61 Disc Rotor Unit ( $\phi$ 160 mm)
	Y-8HM98010	SM-RT53 Disc Rotor Unit ( $\phi$ 160 mm)
* 17	Y-8HM98030	SM-RT53M Disc Rotor Unit ( $\phi$ 180 mm)
* 17	Y-8HM98050	SM-RT53L Disc Rotor Unit ( $\phi$ 203 mm)
* 18	Y-8HH98010	SM-RT51 Disc Rotor Unit ( $\phi$ 160 mm)
* 18	Y-8HH98020	SM-RT51M Disc Rotor Unit ( $\phi$ 180 mm)

0707-2429D

Specifications are subject to change without notice.

# SHIMANO